



Vertical Coiling with Fixed Egress

SAFESCAPE® T5000 Series

This fire and smoke rated door assembly is designed to coil at the top allowing the rigid bottom frame with fixed egress doors to lower when deployed. Once in place, the single or multiple swinging egress doors provide complying egress. Large occupant loads and wide-span openings are easily accommodated by the McKeon T5000.

Safescape® Model T5006 | Vertical Acting Fire Door with Multiple Fixed Egress Doors



Safescape® Model T5007 | Vertical Acting with Multiple Fixed Egress Doors



T5000 Series fire door systems are a design advantage when there is no side room available for pocket storage. Concealed above the ceiling line, no additional building space is required. The T5000 assembly is available with as many as 18 conventional fixed egress doors to accommodate large occupant load exit width requirements and facilitate circulation during an emergency – a feature that is especially desirable in a retail environment.

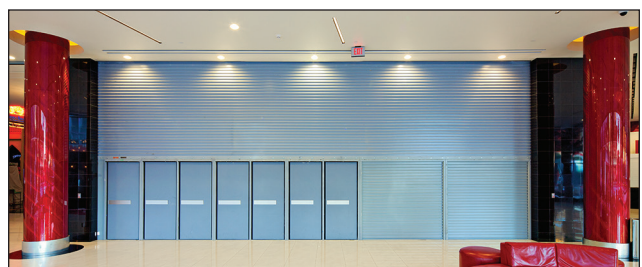

T5000 with Multiple Fixed Egress Doors: Main Components

- | | |
|-----------------------------------|--------------------------------|
| 1 Fire Door Motor Operator | 4 Fire Exit Hardware |
| 2 Hood | 5 Swinging Egress Doors |
| 3 Curtain Slats | |

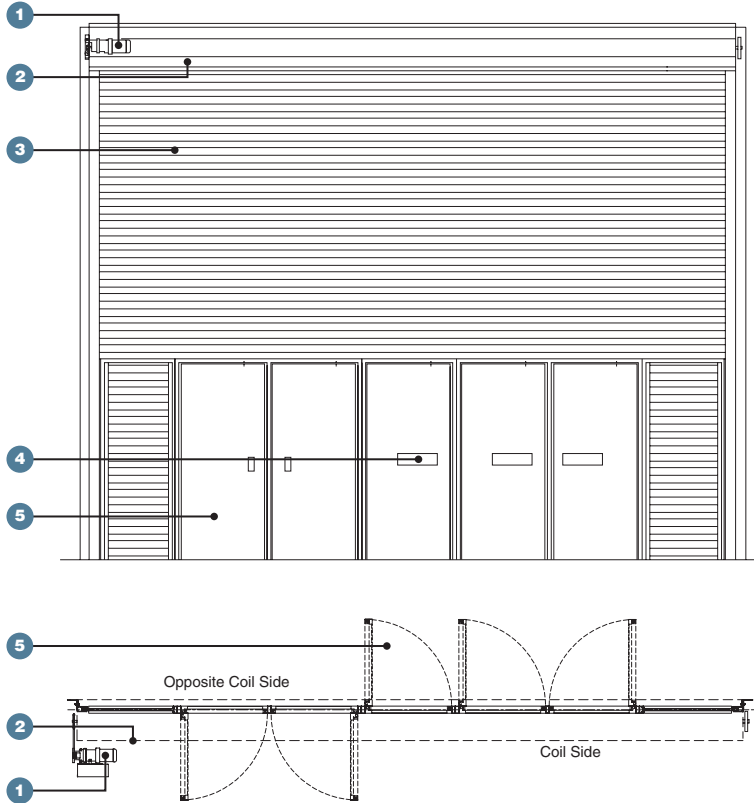

Note: Egress doors may swing in opposite directions.

Product Features

Ratings

3-hour rated UL 10B*

90-minute rated assembly available with a 650° F over 30 minute Temperature Rise rating when required

Smoke & Draft labeled UL 1784

Code Compliance

CCRR-1086

ADA compliant

Egress

Available with up to 18 complying egress swing doors

Operation

Auto-Set® automatic resetting

Fail-Safe Design - automatic self-closing mechanism does not require power operation to self-close

Size

Unlimited heights and widths to 80'; for larger sizes and custom configurations consult the factory

Finishes

McKeon sterling gray

Powder coat

Stainless steel

*Listed under the Canadian equivalent CAN/ULC S104

MODEL	OPERATION		EGRESS
	Open	Self-Close	
T5000	Auto-Set® Power Operator	Fail-Safe Mechanical	1 Complying Swing Door ²
T5002 - T5018¹	Auto-Set® Power Operator	Fail-Safe Mechanical	2 to 18 Complying Swing Doors ²

¹ The last two digits of the model number indicate the number of swing doors.

² Maximum swing door width is 48".

This technology is the subject of US Patent No. 8,453,707